

SI-173B PROSPOT 300CF

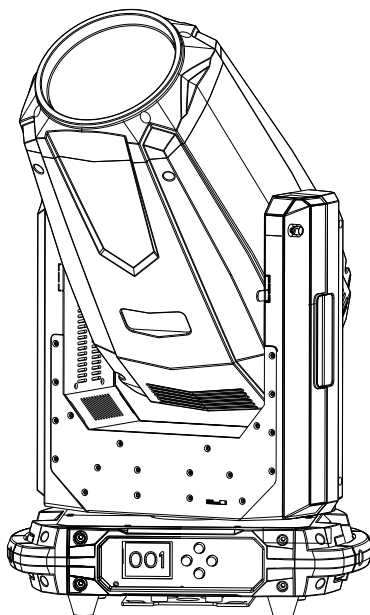

CE   IP20 LED  0.2m  t_a 40°C t_c 150°C

User Manual

KEEP THIS MANUAL FOR FUTURE NEEDS

1

SAFETY INSTRUCTIONS



CAUTION

Becareful with your operations. With a dangerous voltage you cansuffer a dangerous electric shock when touching wires!

This device has left the factory in perfect condition. In order to maintain this condition and to ensure a safe operation, it is absolutely necessary for the user to follow the safety instructions and warning notes written in this user manual.



IMPORTANT

Damages caused by the disregard of this user manual are not subject to warranty. The dealer will not accept liability for any resulting defects or problems.

If the device has been exposed to temperature changes due to environmental changes, do not switch it on immediately. The arising condensation could damage the device. Leave the device switched off until it has reached room temperature.

This device falls under protection-class I. Therefore it is essential that the device be earthed.

The electric connection must carry out by qualified person.

The device shall only be used with rate voltage and frequency.

Make sure that the available voltage is not higher than stated at the end of this manual.

Make sure the power cord is never crimped or damaged by sharp edges. If this would be the case, replacement of the cable must be done by an authorized dealer.

Always disconnect from the mains, when the device is not in use or before cleaning it. Only handle the power cord by the plug. Never pull out the plug by tugging the power cord.

During initial start-up some smoke or smell may arise. This is a normal process and does not necessarily mean that the device is defective, it should decrease gradually.

Please don't project the beam onto combustible substances.

Fixtures cannot be installed on combustible substances, keep more than 50cm distance with wall for smooth air flow, so there should be no shelter for fans and ventilation for heat radiation.

If the external flexible cable or cord of this luminaire is damaged, it shall be exclusively replaced by the manufacturer or his service agent or a similar qualified person in order to avoid a hazard.

2 UNPACKING

Thank you for choosing our PROSPOT 300CF. For your own safety, please read this manual before installing the device. This manual covers the important information on installation and applications. Please install and operate the fixture with following instructions. Meanwhile, please keep this manual well for future needs.

The PROSPOT 300CF is made of a new type of high temperature strength of engineering plastics and cast aluminum casing with nice outlook. The fixture is designed and manufactured strictly following CE standards, complying with international standard DMX512 protocol. It's available independently controlled and linkable with each other for operation. And it is applicable for large-scale live performances, theater, studio, nightclubs and discos.

The PROSPOT 300CF adopts a 270W 8000K cool white LED lamp which features high brightness and stability. Please carefully unpack it when you receive the fixture and check whether it is damaged during the transportation. And please check whether the following items are included inside the box:

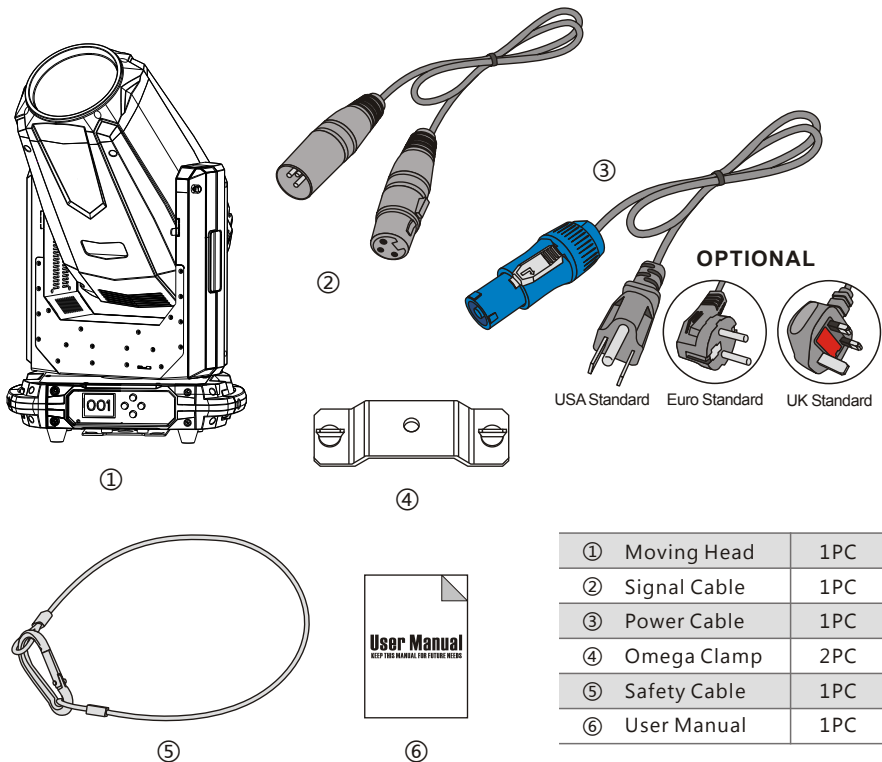

3 FEATURES & SPECIFICATIONS

Features

- A 270W 8000K cool white LED lamp with extremely high brightness, 18000 lumens
- 12600 Lumens due to a set of high resolution and precise optics
- 50000 hours life span and low power consumption
- The life span may vary depending on several following factors but not limited to:
- Environmental Conditions, Power/Voltage, Usage Patterns (On-Off Cycling), Control, and Dimming)
- Flicker free operation for broadcast TV and FILM
- 31000 LUX@5m (3° Min Zoom)
- 720 LUX@5m (50°Max Zoom)
- 3°-50°Smooth and quiet linear motorized zoom
- 8/16 bit smooth, fast and precise resolution for PAN/TILT movement with low noise operation
- 540°PAN and 270°TILT movement
- Fast, quiet, smooth and precise 3-Phase PAN/TILT motors
- PAN/TILT time controllable
- Friendly PAN/TILT locks for better fixture protection
- Scan position memory, auto reposition after unexpected movement
- Full CMY color mixing system with linear CTO color correction
- Fine control available for CMY system
- 1 Color wheel with 7 dichroic colors plus open (available for half color mode)
- Fine control available for color wheel
- Variable direction rainbow effect with speed adjustable
- Color time controllable
- 8-Blade framing shutter system with 95° bi-directional rotation
- Fine control available for framing system
- Multi dynamic and static framing macros available, with variable speed control
- Smooth and quiet linear motorized Iris
- Fine control available for IRIS
- 1 Rotating gobo wheel with 7 rotatable and interchangeable glass gobos plus open with speed adjustable, stream effect, dithering effect and rotatable clockwise or anticlockwise
- Gobo indexing available
- Gobo size 25mm (external dimensions)/21mm (inner dimensions)
- Fine control available for rotating gobos
- 1 Static gobo wheel with 1 Static gobo wheel with 6 gobos plus open (including a gobo reducer and an animation effect gobo)

- Fine control available for static gobos
- Gobo overlay (gobo morphing)
- Gobo time controllable
- 2.5M-15M electric focus
- Fine control available for focus
- 3-Facet rotating prism with variable speed and direction
- Linear rotating prism with variable speed and direction
- Fine control available for prisms
- 0-100% Smooth linear LED dimmer
- Dimmer fine control available
- Variable dimming curve modes
- 25T/sec high speed LED shutter/strobe effect with variable speed
- Preset variable/random strobe and dimming pulse effect
- Frost filter (Hybrid effect for wash)
- 37/40/63 DMX channels USITT DMX-512
- DMX512, master-slave, and sound activated controllable or auto operation
- DMX recorder and edit function integrated
- Sound control with sensitivity adjustment
- RDM available (Remote Device Management)
- Art-NET available
- W-DMX wireless receiver built-in
- 2.4" TFT LCD display (320*240pix) with 4 control buttons and battery back-up for menu preset
- 180° Reversible for LCD display
- LCD display switch-off automatically after 60 seconds
- DMX signal monitoring indicator available
- Software up-datable through DMX connectors
- Efficient low noise self adjusting fan cooling system
- Constant temperature readout and management function
- Over heat protection management
- Powercon IN/ OUT with power switch and fuse
- RJ45 etherCON IN/OUT (Art-NET)
- 3-Pin XLR DMX connectors IN/OUT
- IP20 protection rating
- -20°C to 45°C ambient temperature
- 2*1/4 turn fastening Omega Clamps (Adaptable vertically and horizontally)
- 1* Safety attachment point
- CE (EMC/LVD) and RoHS certified

Specifications

Input Voltage: AC100-240V 50/60Hz

LED Quantities: 1*270W 8000K cool white LED

Control Signal: Art-NET, RDM, DMX512, master-slave and sound activated or auto operation

Control Channel: 37/40/63 DMX channels USITT DMX-512

Power Consumption: 470W

Dimensions: 280(D)*400(W)*686.1(H)mm

Packing Dimensions: 480(D)*600(W)*787(H)mm

Net Weight: 28kg

Gross Weight: 33kg

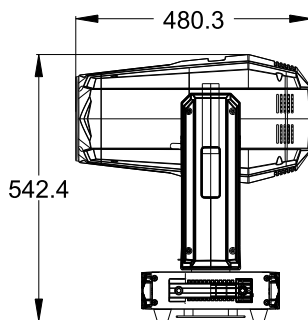
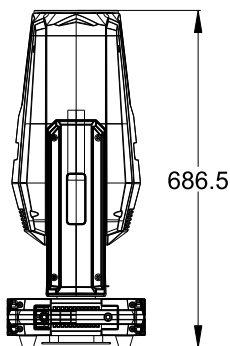
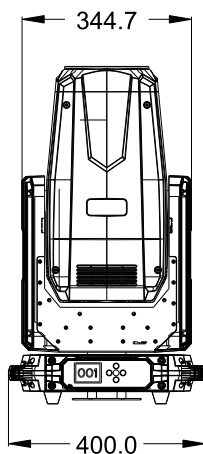

Rotating gobos



Static gobos



Colors

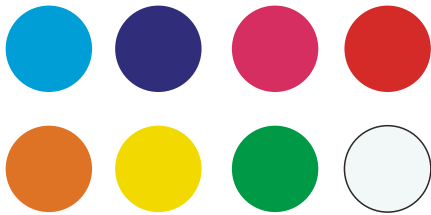

4 PHOTOMETRIC DATA

Photometric Beam Angle Data 3°~50° Beam Angle LUX × 0.0929=FC

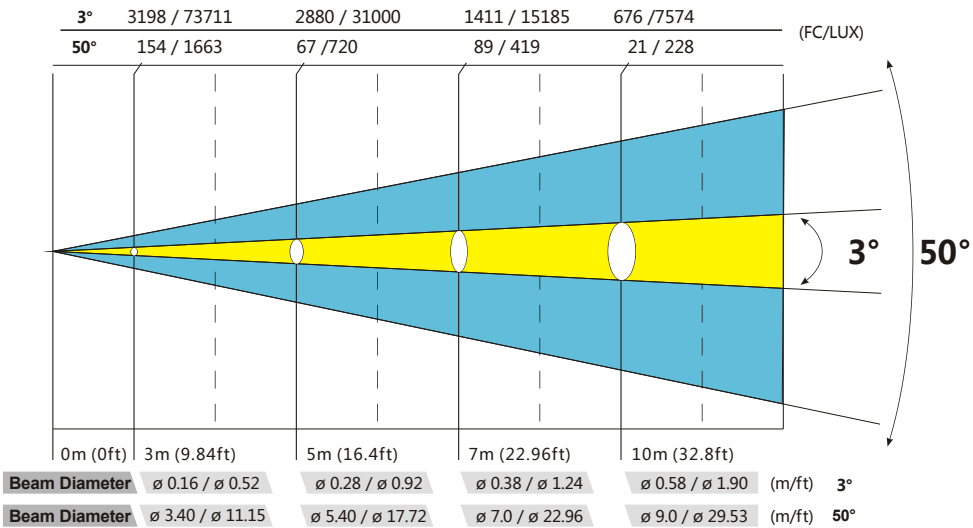

5 OPERATION INSTRUCTIONS

- The PROSPOT 300CF is for beam effect for on-site decoration purpose.
- Don't turn on the fixture if it's been through severe temperature difference like after transportation because it might damage the light due to the environment changes. So make sure to operate the fixture until it is in normal temperature.
- This light should be keep away from strong shaking during any transportation or movement.
- Don't pull up the light by only the head, or it might cause damages to the mechanical parts.
- Don't expose the fixture in overheat, moisture or environment with too much dust when installing it. And don't lay any power cables on the floor. Or it might cause electronic shock to the people.
- Make sure the installation place is in good safety condition before installing the fixture.
- Make sure to put the safety chain and check whether the screws are screwed properly when installing the fixture.
- Make sure the lens are in good condition. It's recommended to replace the units if there are any damages or severe scratch.
- Make sure the fixture is operated by qualified personnel who knows the fixture before using.
- Keep the original packages if any second shipment is needed.
- Don't try to change the fixtures without any instruction by the manufacturer or the appointed repairing agencies.
- It is not in warranty range if there are any malfunctions from not following the user manual to operate or any illegal operation, like shock short circuit, electronic shock, lamp broke, etc.

6 INSTALLATIONS

Cautions: For added protection mount the fixtures in areas outside walking paths, seating areas, or in areas where the fixture might be reached by unauthorized personnel.

Before mounting the fixture to any surface, make sure that the installation area can hold a minimum point load of 10 times the device's weight.

Fixture installation must always be secured with a secondary safety attachment, such as an appropriate safety cable.

Never stand directly below the device when mounting, removing, or servicing the fixture.

from a ceiling, or set on a flat level surface (see illustration below). Be sure this fixture is kept at least 0.5m (1.5 ft) away from any flammable materials (decoration etc.).

Always use and install the supplied safety cable as a safety measure to prevent accidental damage and/or injury in the event the clamp fails.

Mounting points: Overhead mounting requires extensive experience, including amongst others calculating working load limits, a fine knowledge of the installation material being used, and periodic safety inspection of all installation material and the fixture. If you lack these qualifications, do not attempt the installation yourself. Improper installation can result in bodily injury.

Be sure to complete all rigging and installation procedures before connecting the main power cord to the appropriate wall outlet.

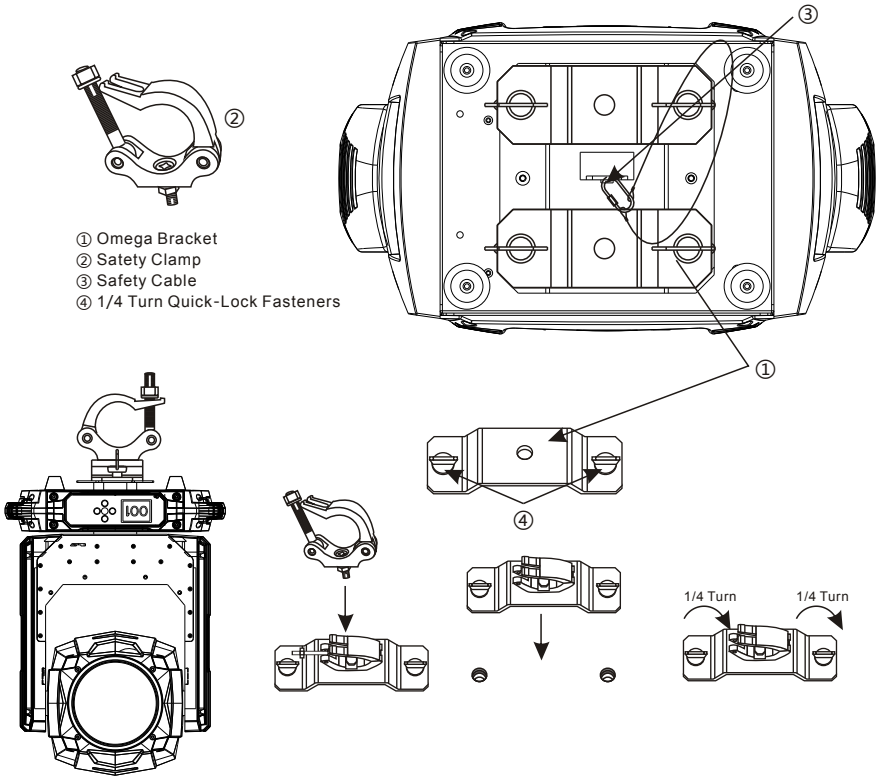

Clamp Mounting: The PROSPOT 300CF provides two unique mounting bracket assembly that integrates the bottom of the base, the included “Omega Bracket,” and the safety cable rigging point in one unit (see the illustration below). When mounting this fixture to truss be sure to secure an appropriately rated clamp to the included omega bracket using a M10 screw fitted through the center hole of the “omega bracket”. As an added safety measure be sure to attached at least one properly rated safety cable to the fixture using on of the safety cable rigging point integrated in the base assembly.

Regardless of the rigging option you choose for your PROSPOT 300CF, always be sure to secure your fixture with a safety cable. The fixture provides a built-in rigging point for a safety cable on the hanging bracket as illustrated above. Be sure to only use the designated rigging point for the safety cable and never secure a safety cable to a carrying handle.

7 DMX-512 CONTROL CONNECTIONS

Connect the provided XLR cable to the female 3-pin XLR output of your controller and the other side to the male 3-pin XLR input of the moving head. You can chain multiple Moving head together through serial linking. The cable needed should be two core, screened cable with XLR input and output connectors. Please refer to the diagram below.

DMX-512 connection with DMX terminator

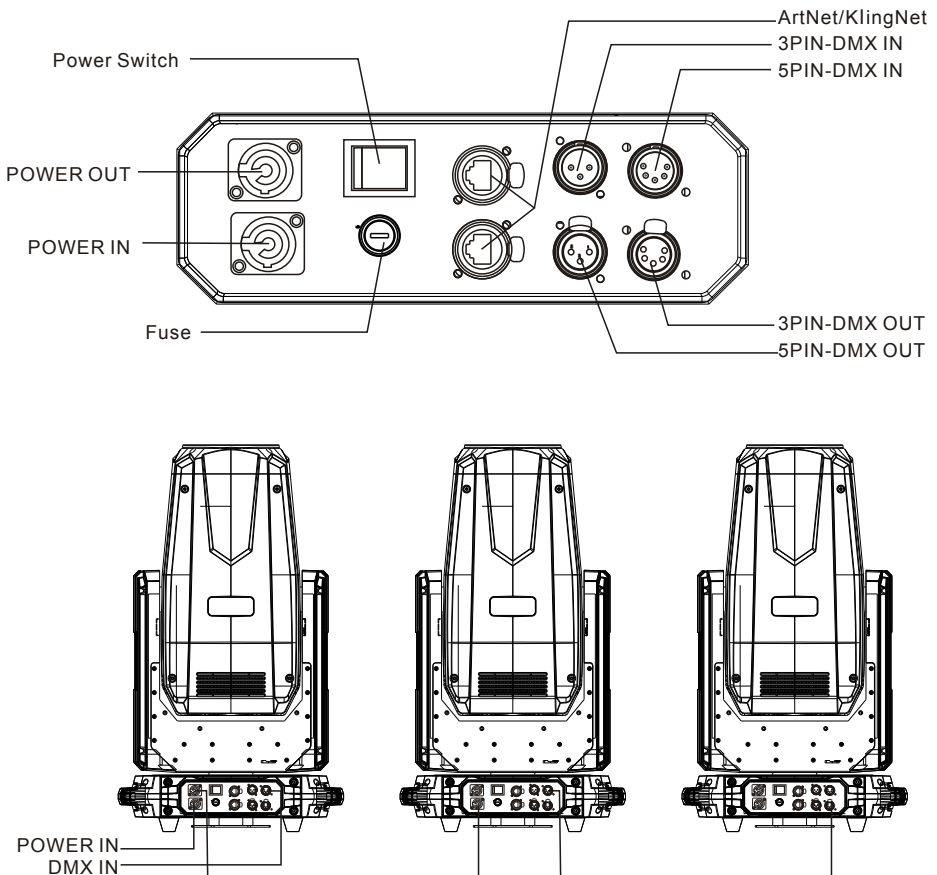

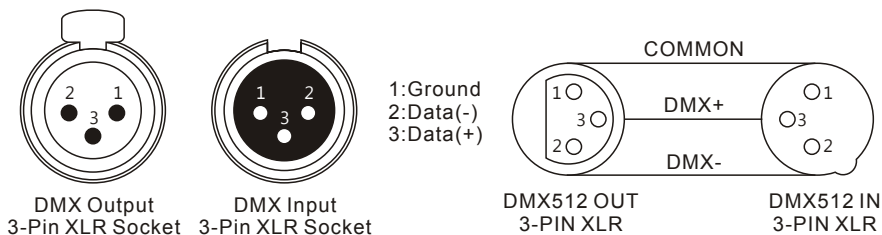

For installations where the DMX cable has to run a long distance or is in an electrically noisy environment, such as in a discotheque, it is recommended to use a DMX terminator. This helps in preventing corruption of the digital control signal by electrical noise. The DMX terminator is simply an XLR plug with a $120\ \Omega$ resistor connected between pins 2 and 3, which is then plugged into the output XLR socket of the last fixture in the chain. Please see illustrations below.

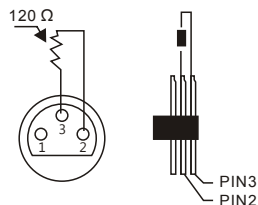

8 MENU OPERATIONS

MENU	Top Level Menu	Second Level Menu	Thrid Level Menu	Description
	Dmx Address			Up and Down to Set Address.Enter to Store it
	Reset			Enter 2 rimes to Reset Fixture
	Dmx Options	Dmx Mode	Standard Mode	
		Loss of DMX	Extended Mode	
			Normal Time Out	When DMX is Lost, Turn off LED's after 2 seconds
			Hold Last Position	When DMX is Lost, Hold Same DMX Value until Power Off Reset
			Run as Master	When DMX Lost, Run Stand Alone Program as Master
			Run as Slave	When DMX is Lost, Run Stand Alone Program as Slave
			Run Static Scene	When DMX is Lost, Run User Programable Static Scene
		Factory Settings		Details in another Document
	Display Options	Display Mode	Always On	LCD Backlight always On
			Off After Delay	LCD Backlight Turns off after Delay
		Dispalay Invert	Off	View From Fixture Base Down
			On	View From Fixture Base UP
		Display Dimming	0~255(Full)	Set Display Backlight Brightness From Dimmest to Brightest
	Information	RDM Device Label		Displays RDM Device label any RDM Control can read or Write that names this fixture
		Electronic SN		RDM Unique Device Address
		Motor Driver Faults		
		Pan Encoder Information		
		Tilt Encoder Information		
		View DMX Values	1~512	View Raw DMX Data from Control
		Soft Version	Display Board	Display System and Boot Software Versions
			Pan and Tilt Board	Display System and Boot Software Versions of XY
			Motor Driver Board 1	Display System and Boot Software Versions of Motor Driver PCB 1
			Motor Driver Board 2	Display System and Boot Software Versions of Motor Driver PCB 2
			Motor Driver Board 3	Display System and Boot Software Versions of Motor Driver PCB 3
			Led Driver	Display System and Boot Software Versions LED Driver PCB
		Temperature	Display Board	Temperature Sensor on Display PCB
			Pan and Tilt Board	Temperature Sensor on Pan and Tilt Board
			Motor Driver Board 1	Temperture Sensor on Motor Driver PCB 1

MENU		Temperature	Motor Driver Board 2	Temperature Sensor on Motor Driver PCB 2
			Motor Driver Board 3	Temperature Sensor on Motor Driver PCB 3
			Led Driver Board	Temperature Sensor on LED Driver PCB
			Led NTC Sensor	Temperature Sensor on LED Plate
	Stand Alone	Dmx Operation		Run in Normal DMX Mode
		Master Mode	Select Memory	
		Slave Mode	Select Memory	
		Static Scene		
	User Memories			Edit User Memories for Stand Alone(Detailed in another Document)
	Fixture Options	Dim Cure	Square Law	Square Law Dim(similar to Eye Response)
			Inverted Square Law	Inverted Square Law
			S-Curve	Cosine Curve with Finer Adjustment and Lowest and Brightest Levels
			Linear	Electronically Linear
		Dim Speed	Smooth	Natural Smooth Dimming
			Fast	Fast Dimming that might not be smooth to the Eye
		Pan Invert	Off-On	Pan Normal or Opposite Direction
		Tilt Invert	Off-On	Tilt Travels Normal of Opposite Direction
		Pan Tilt Swap	Off-On	Pan responds to Tilt Channels, Tilt Responds to Pan Channels
		Dim Invert	Off-On	
		Iris Invert	Off-On	
		Zoom Invert	Off-On	
		Defaults Mode		Restore Fixture Options to Factory Defaults
	Test Modes	Factory Setup	Off	
			On	
		Self Test	Off	
			On	
	Wireless Options	Wireless Priority	Wireless Has Priority	Wireless Signal will be used if both Wireless and XLR have signal
			XLR has Priority	XLR Signal will be used if both Wireless and XLR have signal
			Wireless Only	Wireless Signal will be used Only
			XLR Only	XLR Signal will be used Only
		Un Link Wireless	Wireless to XLR	Wireless Signal to be transmitted back out on XLR
				Disconnect Wireless Radio (same as pushing the button on a WDMX board)

LCD DISPLAY

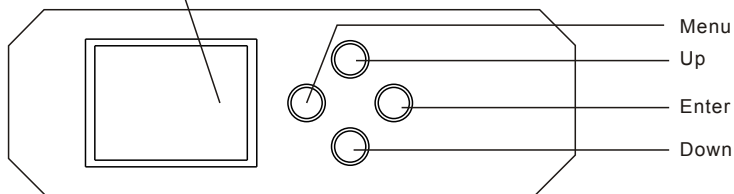

9 DMX CHANNELS

Mode/Channel			Function	Values	Description
BA	ST	EX			
1	1	1	Pan	0-255	Pan movement
	2	2	Pan-fine	0-255	Fine control of pan movement
2	3	3	Tilt	0-255	Tilt
	4	4	Tilt-fine	0-255	Fine control of Tilt movement
3	5	5	Pan/Tilt Speed	0	Normal Tracking
				1-255	Fast to Slow Movement Speed
4	6	6	Strobe	0-3	Shutter Open
				4-103	Linear Strobe from Slow to Fast
				104-107	Shutter Open
				108-207	Pulse strobe from slow to fast
				208-212	Random Strobe Slow
				213-225	Random Strobe Medium
				226-238	Random Strobe Fast
				239-255	Shutter Open
5	7	7	Dimmer	0-255	Dimmer 0-100%
		8	Dim fine	0-255	Dimmer fine 0-100%
	8	9	Dimmer curves modes		Square law
					Inv Square law
					S-curve
					Linear
		10	Dimmer speed	0-255	Smooth-fast
6	9	11	Cyan	0-255	Cyan
		12	Cyan fine	0-255	Cyan fine adjustment

7	10	13	Magenta	0-255	Magenta
		14	Magenta fine	0-255	Magenta fine adjustment
8	11	15	Yellow	0-255	Yellow
		16	Yellow fine	0-255	Yellow fine adjustment
9	12	17	CMY macro	0-15	No function
				16-127	Fixed color presets
				128-255	RGB cycle slow-fast
10	13	18	CTO	0-255	CTO
		19	CTO fine	0-255	CTO fine adjustment
11	14	20	Fixed colors	0-7	Open
				8-15	Half color open 1
				16-23	Full color 1
				24-30	Half color 1-2
				31-38	Full color 2
				39-45	Half color 2-3
				46-53	Full color 3
				54-60	Half color 3-4
				61-68	Full color 4
				69-75	Half color 4-5
				76-83	Full color 5
				84-90	Half color 5-6
				91-98	Full color 6
				99-105	Half color 6-7
				106-113	Full color 7
				114-120	Half color 7-open
				121-128	Open white
				129-192	CW color rotation fast-slow
				193-199	Rotation stop
				200-255	CCW color rotation slow-fast
		21	Color wheel fine	0-255	Color wheel fine adjustment
12	15	22	Iris	0-255	Linear iris 0-100%
		23	Iris fine	0-255	Iris fine adjustment
13	16	24	Gobo wheel #1(fixed)	0-6	Open
				7-14	Gobo 1
				15-21	Gobo 2
				22-28	Gobo 3
				29-35	Gobo 4
				36-41	Gobo 5
				42-49	Gobo 6

13	16	24	Gobo wheel #1 (fixed)	50-56	Gobo 7
				57-64	Animation(gobo 7)
				65-71	Gobo 1 shake
				72-79	Gobo 2 shake
				80-87	Gobo 3 shake
				88-95	Gobo 4 shake
				96-103	Gobo 5 shake
				104-111	Gobo 6 shake
				112-127	Gobo 7 shake
				128-181	CW gobo wheel 1 rotation
				182-191	Rotation stop
				192-234	CCW gobp wheel rotation slow-fast
			Note: use with channel 11	235	No function
				236	Macro: smooth
				238	Macro: Oraganic
				240	Macro: Metronome
				242	Macro: slow forward/fast reverse
				244	Macro: slow reverse/fast forward
				246	Macro:rabdom bounce
				248	Macro:interference
				250	Macro:random animation
				252	Macro:random gobo
				255	Macro:random both
14	17	25	Gobo#1 macro speed	0-255	Macro from fast-slow
		26	Gobo wheel 1 fine\	0-255	Gobo wheel fine adjustment
15	18	27	Gobo wheel #2 (rotating)	0-8	Open
				9-16	Gobo 1
				17-24	Gobo 2
				25-32	Gobo 3
				33-40	Gobo 4
				41-48	Gobo 5
				49-56	Gobo 6
				57-64	Gobo 7
				65-72	Gobo 1 shake
				73-80	Gobo 2 shake
				81-88	Gobo 3 shake
				89-96	Gobo 4 shake
				97-104	Gobo 5 shake
				105-112	Gobo 6 shake

15	18	27	Gobo wheel #2 (rotating)	113-127	Gobo 7 shake
				128-189	CW rotating gobo cycle fast-slow
				190-193	Stop
				194-255	CCW rotating gobo cycle slow-fast
16	19	28	Gobo#2 rotate/ index (coarse)	0-127	Insexing
				128-189	Rotate CW fast-slow
				190-193	Stop
				194-255	Rotate CCW slow-fast
		29	Gobo#2 index (fine)	0-255	Fine indexing
17	20	30	Framing 1:1	0-255	Shutter 1 position 1
		31	Framing 1:1 fine	0-255	Framing 1:1 fine adjustment
18	21	32	Framing 1:2	0-255	Shutter 1 position 2
		33	Framing 1:2 fine	0-255	Framing 1:2 fine adjustment
19	22	34	Framing 2:1	0-255	Shutter 2 position 1
		35	Framing 2:1 fine	0-255	Framing 2:1 fine adjustment
20	23	36	Framing 2:2	0-255	Shutter 2 position 2
		37	Framing 2:2 fine	0-255	Framing 2:2 fine adjustment
21	24	38	Framing 3:1	0-255	Shutter 3 position 1
		39	Framing 3:1 fine	0-255	Framing 3:1 fine adjustment
22	25	40	Framing 3:2	0-255	Shutter 3 position 2
		41	Framing 3:2 fine	0-255	Framing 3:2 fine adjustment
23	26	42	Framing 4:1	0-255	Shutter 4 position 1
		43	Framing 4:1 fine	0-255	Framing 4:1 fine adjustment
24	27	44	Framing 4:2	0-255	Shutter 4 position 2
		45	Framing 4:2 fine	0-255	Framing 4:2 fine adjustment

25	28	46	Frame rotation	0-255	90-degree framing shutter rotation
		47	Frame rotation fine	0-255	Fine framing rotation
26	29	48	Static framing macro	0-4	No function
				5-9	Macro 01-1
				10-14	Macro 01-2
				15-19	Macro 01-3
				20-24	Macro 01-4
				25-29	Macro 02-1
				30-34	Macro 02-2
				35-39	Macro 03-1
				40-44	Macro 03-2
				45-49	Macro 04-1
				50-54	Macro 04-2
				55-59	Macro 05-1
				60-64	Macro 05-2
				65-69	Macro 05-3
				70-74	Macro 05-4
				75-79	Macro 06-1
				80-84	Macro 06-2
				85-89	Macro 07-1
				90-94	Macro 07-2
				95-99	Macro 08-1
				100-104	Macro 08-2
				105-109	Macro 09-1
				110-114	Macro 09-2
				115-119	Macro 09-3
				120-124	Macro 09-4
				125-129	Macro 10-1
				130-134	Macro 10-2
				135-139	Macro 10-3
				140-144	Macro 10-4
				145-149	Macro 11-1
				150-154	Macro 11-2
				155-159	Macro 11-3
				160-164	Macro 11-4
				165-169	Macro 12-1
				170-174	Macro 12-2
				175-179	Macro 12-3
				180-184	Macro 12-4
				185-189	Macro 13-1

26	29	48	Static framing macro	190-194	Macro 13-2
				195-199	Macro 13-3
				200-204	Macro 13-4
				205-255	Reserved
27	30	49	Dynamic framing macro	0-9	No function
				10-19	Macro 01
				20-29	Macro 02
				30-39	Macro 03
				40-49	Macro 04
				50-59	Macro 05
				60-69	Macro 06
				70-79	Macro 07
				80-89	Macro 08
				90-99	Macro 09
				100-109	Macro 10
				110-119	Macro 11
				120-129	Macro 12
				130-139	Macro 13
				140-149	Macro 14
				150-159	Macro 15
				160-169	Macro 16
				170-255	Reserved
28	31	50	Speed	0-255	Speed control of dynamic framing macro
29	32	51	Rotating prism, prism/ gobo macro	0-9	No function
				10-19	Macro 01
				20-29	Macro 02
				30-39	Macro 03
				40-49	Macro 04
				50-59	Macro 05
				60-69	Macro 06
				70-79	Macro 07
				80-89	Macro 08
				90-99	Macro 09
				100-109	Macro 10
				110-119	Macro 11
				120-129	Macro 12
				130-139	Macro 13
				140-149	Macro 14
				150-159	Macro 15
				160-169	Macro 16
				170-255	Reserved
30	33	52	Prism 1 in/out	0-6	Prism out
				7-255	Prism in

31	34	53	Prism 1 rotate	0-127	Static Positioning
				128-189	Rotate CW fast-slow
				190-193	Stop
				194-255	Rotate CCw slow-fast
		54	Prism 1 positioning fine	0-255	Prism 1 positioning fine adjustment
32	35	55	Prism 2 in/out	0-6	Prism out
				7-255	Prism in
33	36	56	Prism 2 rotate	0-127	Static positioning
				128-189	Rotate CW fast-slow
				190-193	Stop
				194-255	Rotate CCW slow-fast
		57	Prism 2 positioning fine	0-255	Prism 2 positioning fine adjustment
34	37	58	Linear frost in/out	0-255	Out-in 0-100%
35	38	59	Zoom	0-255	Narrow-wide
		60	Zoom fine	0-255	Zoom fine adjustment
36	39	61	Focus	0-255	Near-far
		62	Focus fine	0-255	Focus fine adjustment
37	40	63	Control	0-39	No function
				40-49	Pan/Tilt motor reset
				50-59	Head motors reset
				60-69	Reset all
				70-79	No function
				80-89	Set move-in-black active
				90-99	Cancel move-in-black
				100-109	Set color change-in-black active
				110-119	Cancel gobo change-in-black
				120-129	Set gobo change -in-black active
				130-139	Cancel gobo change-in-black
				140-149	No function
				150-159	Internal program 1
				160-169	Internal program 2
			
				220-229	Internal program 8
				230-255	No function

10 MAINTENANCE AND CLEANING

The following points have to be considered during the inspection:

- 1) All screws for installing the devices or parts of the device have to be tightly connected and must not be corroded.
- 2) There must not be any deformations on the housing, color lenses, fixations and installation spots (ceiling, suspension, trussing).
- 3) Mechanically moved parts must not show any traces of wearing and must not rotate with unbalances.
- 4) The electric power supply cables must not show any damage, material fatigue or sediments.

Further instructions depending on the installation spot and usage have to be adhered by a skilled installer and any safety problems have to be removed.



CAUTION

Disconnect from mains before starting maintenance operation.



In order to make the lights in good condition and extend the life time, we suggest a regular cleaning to the lights.

- 1) Clean the inside and outside lens each week to avoid the weakness of the lights due to accumulation of dust.
- 2) Clean the fan each week.
- 3) A detailed electric check by approved electrical engineer each three month, make sure that the circuit contacts are in good condition, prevent the poor contact of circuit from overheating.

We recommend a frequent cleaning of the device. Please use a moist, lint- free cloth. Never use alcohol or solvents.

There are no serviceable parts inside the device. Please refer to the instructions under "Installation instructions".

Should you need any spare parts, please order genuine parts from your local dealer.



ADD 3rd Floor, No. 288, Guangzhu East Line, Pingwen, Lanhe Town, Nansha District,
Guangzhou, China

Tel. +86 20 8499 2310/2320/2330

Fax +86 20 8499 2360

E-mail info@color-imagination.com

Website www.color-imagination.com

**Follow
us on**



www.facebook.com/color.imagination.1



www.youtube.com/user/colorimaginationj



twitter.com/colorimaginej